



95,807 SF
Available March 1, 2026

LogistiCenter® at Rialto Warehouse/Distribution

1642 W. Miro Way, Suite A, Rialto, CA 92376

D | **DERMODY**

CBRE

[Dermody.com](https://www.Dermody.com)

Building Specifications

1642 W. Miro Way, Suite A, Rialto, CA 92376

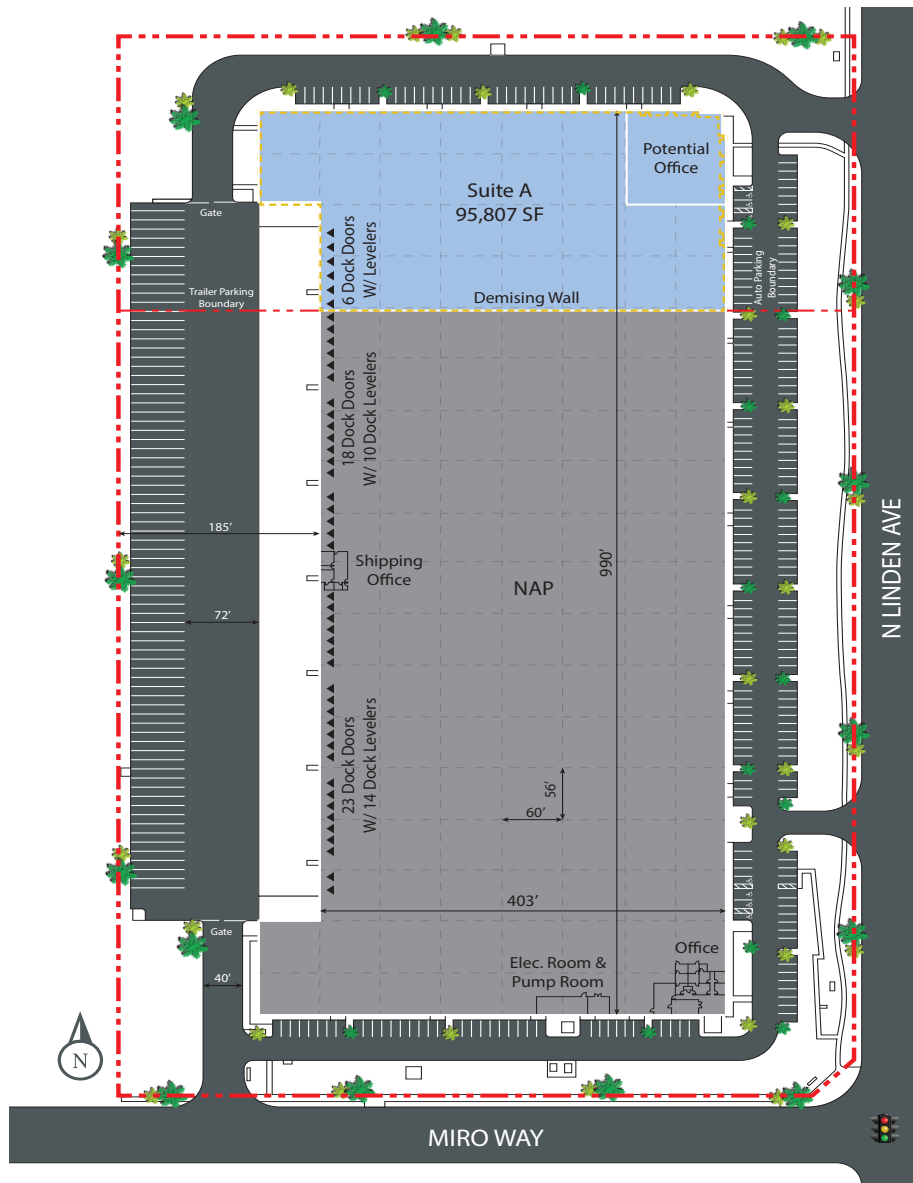

Building Specifications

Building Size	95,807 SF POL 411,330 SF
Office Area	BTS
Clear Height	36'
Column Spacing	60' x 56' (60' at Staging Bay)
Truck Court Depth	185'
Building Depth	403'
Dock-High Doors	6
Grade-Level Doors	1
Car Parking	approx. 68
Trailer Parking	approx. 12
Power	Main Switch Gear Rated for 2,000 amps. 277/480v, 3 phase, 4-wire
Sprinkler System	ESFR, K-25 Heads
Lighting	LED Warehouse Fixtures Provided to Achieve 30 FC at Speed Bay and 20 FC for General Lighting
Floors	7" Thick oncrete Slab Un-Reinforced 4,000 PSI
Warehouse Finishes	Interior Walls Painted & White Foil Insulation
Food Grade Facility	Caulked Floor Joints 18" Exterior Pavement/Impervious Against Outside of Building

Location

Brought to you by Dermody, the LogistiCenter® at Rialto is located at 1642 W. Miro Way in the City of Rialto. It is strategically located in between the I-210, I-15 and I-215 freeways in Rialto, CA. The property provides an excellent location to service both Southern California and the Western United States.

The property is 15.2 miles away from the Ontario International Airport and 13.4 miles away from the San Bernardino International Airport. It is approximately 70 miles from the Ports of Los Angeles & Long Beach.

Ports & Transportation	Miles
Ports of LA & Long Beach	70.0
Ontario Intl. Airport	14.5
San Bernardino Intl. Airport	13.4
I-210 Freeway	2.0
I-15 Freeway	6.3
I-215 Freeway	6.4





Building Exterior



Truck Court



Building Exterior



LogistiCenter® at Rialto

1642 W. Miro Way, Suite A, Rialto, CA

About Dermody

Dermody is a privately-owned real estate investment, development and management firm that specializes in the acquisition and development of logistics real estate in strategic locations for e-commerce fulfillment centers, third-party logistics and distribution customers. Founded in 1960, Dermody has invested more than \$10 billion of total capital across all platforms nationwide, having acquired and developed approximately 110 million square feet of logistics and industrial facilities. In addition to its corporate office in Reno, Nevada, it has regional offices in Atlanta, Chicago, Dallas, Indianapolis, New Jersey, Northern California, Phoenix, Seattle and Southern California. For more information, visit www.Dermody.com.

About the LogistiCenter® Brand

LogistiCenter® is a national trademark brand, owned and developed by Dermody. It represents the firm's business philosophy of developing Class A distribution facilities that meet the supply-chain requirements of the most innovative companies. All LogistiCenter® facilities are designed to meet best practices in sustainable design and construction, and incorporate building features, such as additional clear height and extra trailer and car parking, that enable companies to execute their operations more effectively and efficiently.

About Broker

CBRE, Inc. 4141 Inland Empire Blvd #100, Ontario, CA 91764 | 909-418-2000

© 2026 CBRE, Inc. All rights reserved. This information has been obtained from reliable sources but has not been verified for accuracy or completeness. CBRE, Inc. makes no guarantee, representation, or warranty and accepts no responsibility or liability for the accuracy, completeness, or reliability of the information contained herein. You should conduct a careful, independent investigation of the property and verify all information. Any reliance on this information is solely at your own risk. CBRE and the CBRE logo are service marks of CBRE, Inc. All other marks displayed on this document are the property of their respective owners, and the use of such marks does not imply any affiliation with or endorsement of CBRE. Photos herein are the property of their respective owners. Use of these images without the express written consent of the owner is prohibited.

CBRE

Dan de la Paz

Lic. 01233784

Vice Chairman

(909) 418-2169

dan.delapaz@cbre.com

David Consani

Lic. 00866234

Executive Vice President

(909) 418-2005

david.consani@cbre.com

Jim Koenig

Lic. 00905257

Executive Vice President

(909) 418-2008

jim.koenig@cbre.com

D | DERMODY

Dermody.com