



±10,642 SF Unit
Available Now!

INQUIRE ABOUT SPECIAL PROMOTIONS AVAILABLE!

PAMA
DISTRIBUTION CENTER

1385 E. Pama Lane, Las Vegas, NV 89119

D | DERMODY

CBRE

Dermody.com

Site Plan

■ = LEASED

● = GRADE-LEVEL DOOR

■ = AVAILABLE

▲ = DOCK-HI DOOR

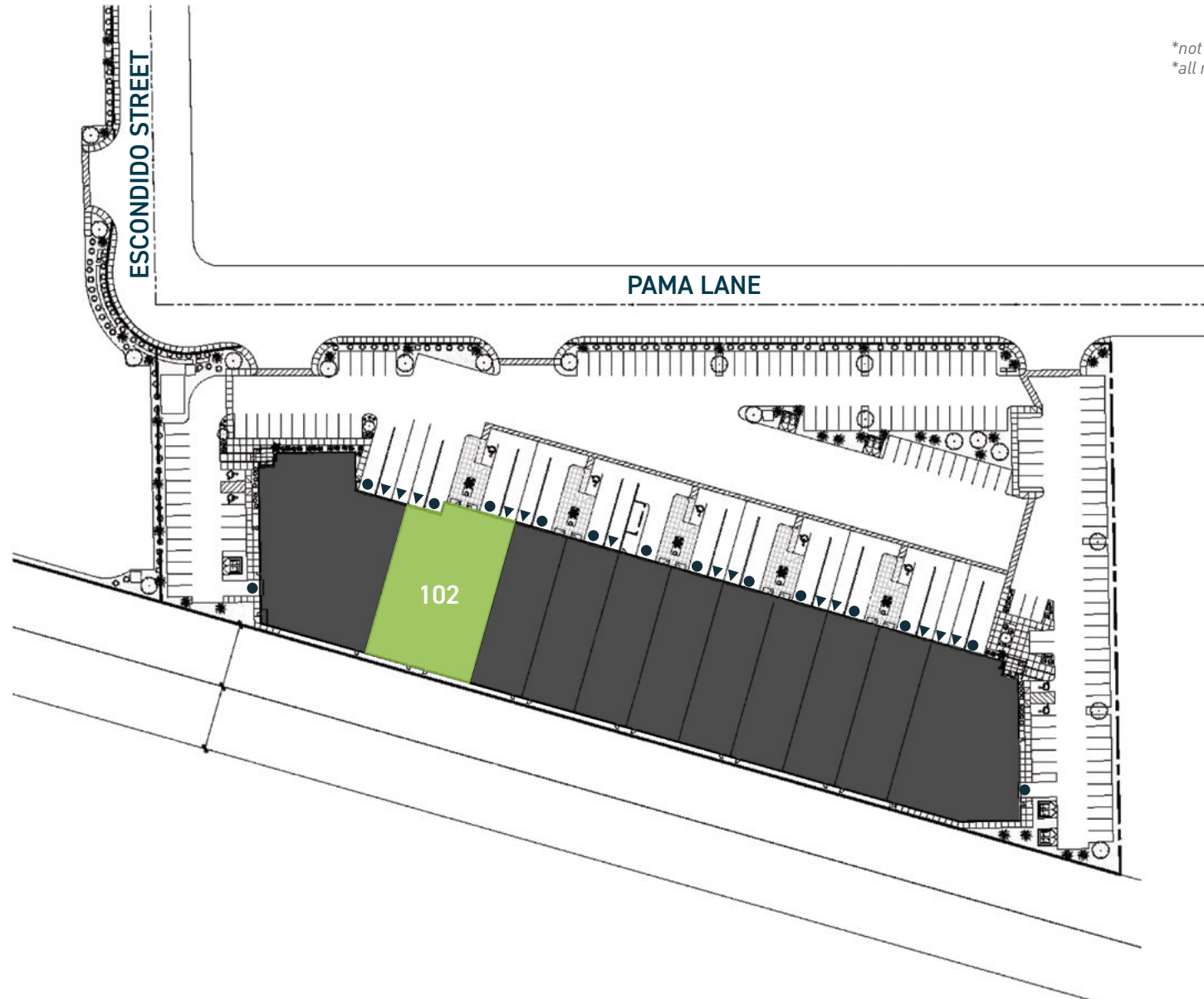

**not to scale
all measurements are approximate



Suite 102

INQUIRE ABOUT SPECIAL PROMOTIONS AVAILABLE!

Floorplan

- = Grade-Level Door
- ▲

 = Dock-Hi Door

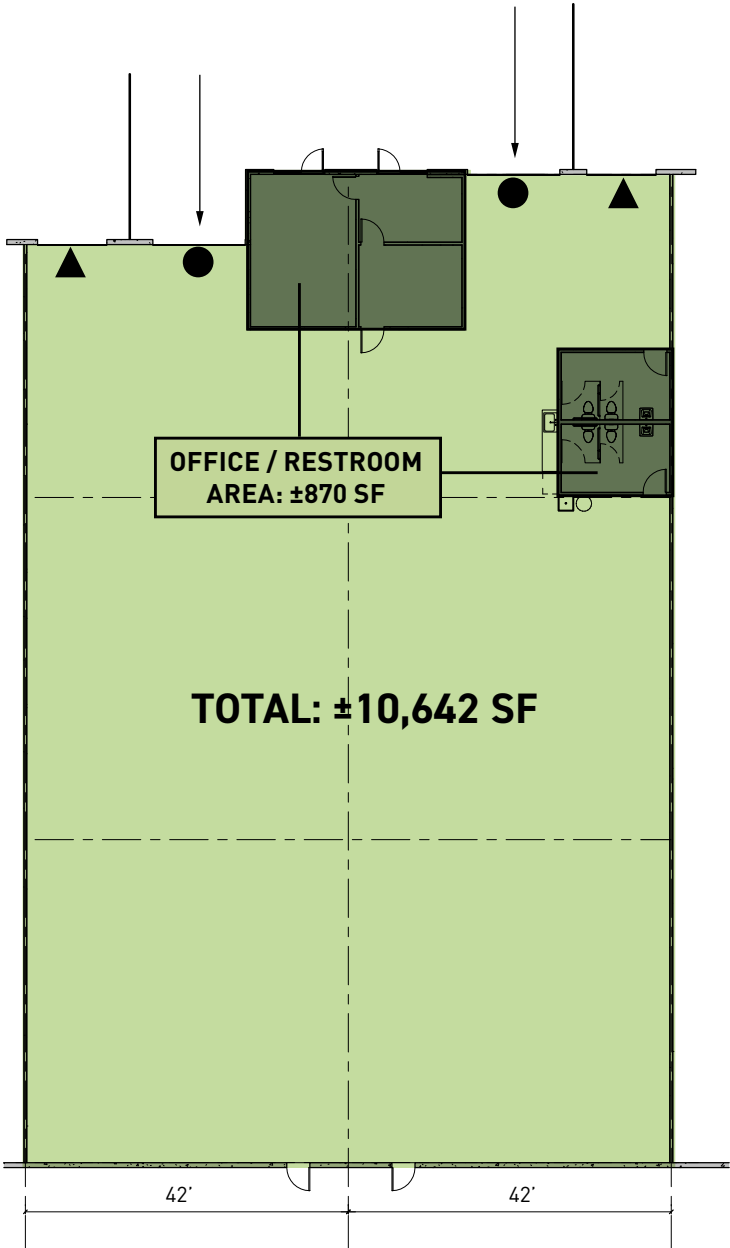

SPACE OVERVIEW

TOTAL RENTABLE AREA	±10,642 SF
OFFICE BUILDOUT	870 SF turn-key office
WAREHOUSE CLEARANCE	28'
TRUCK COURT DEPTH	120'
ELECTRICAL POWER	800 amps, 277/480v, 3-Phase
DOCK HI DOORS	Two (2) 9' x 10'
GRADE LEVEL DOORS	Two (2) 12' x 14'
LIGHTING	LED High Bay, with skylights
ZONING	IP (Industrial Park)
CAR PARKING RATIO	2.07 per 1,000
SPRINKLER SYSTEM	ESFR System
LEASE RATE	Call For Information
CAMS	Est. \$0.277/SF/Mo.
LEASE TERM	Minimum 5 Years



Location Overview

Located in the highly-desirable Airport Submarket, minutes from the Las Vegas Strip, Harry Reid International Airport, and the I-15/I-215 Freeway Interchange.

Distances To:	Miles
I-215 Freeway	2.1
I-15 Freeway	3.8
Harry Reid Int'l Airport	3.9
Las Vegas "Strip"	3.7



PAMA

DISTRIBUTION CENTER

1385 East Pama Lane
Las Vegas, NV 89119

About Dermody

Dermody is a privately-owned real estate investment, development and management firm that specializes in the acquisition and development of logistics real estate in strategic locations for e-commerce fulfillment centers, third-party logistics and distribution customers. Founded in 1960, Dermody has invested more than \$10 billion of total capital across all platforms nationwide, having acquired and developed approximately 110 million square feet of logistics and industrial facilities. In addition to its corporate office in Reno, Nevada, it has regional offices in Atlanta, Chicago, Dallas, Indianapolis, New Jersey, Northern California, Phoenix, Seattle and Southern California. For more information, visit www.Dermody.com.

About Broker

© 2025 CBRE, Inc. All rights reserved. This information has been obtained from sources believed reliable but has not been verified for accuracy or completeness. CBRE, Inc. makes no guarantee, representation or warranty and accepts no responsibility or liability as to the accuracy, completeness, or reliability of the information contained herein. You should conduct a careful, independent investigation of the property and verify all information. Any reliance on this information is solely at your own risk. CBRE and the CBRE logo are service marks of CBRE, Inc. All other marks displayed on this document are the property of their respective owners, and the use of such marks does not imply any affiliation with or endorsement of CBRE. Photos herein are the property of their respective owners. Use of these images without the express written consent of the owner is prohibited.

CBRE

LAUREN WILLMORE

Senior Associate

(702) 290-7920

lauren.willmore@cbre.com

Lic: S. 0188698

D | DERMODY

JOHN RAMOUS

Nevada Partner

(775) 335-0172

jramous@dermody.com

Dermody.com