

# KR Kiley Ranch Commerce Center

Developed by Dermody Properties

## Contact Information:

J. Michael Hoeck, SIOR

Direct: 775-336-4621

Email: jmhoeck@naialliance.com

Michael Nevis, CCIM

Direct: 775-336-4623

Email: mnevis@naialliance.com

Scott Shanks, SIOR

Direct: 775-336-4671

Email: sshanks@naialliance.com

## SITE PLAN

### SITE DATA SUMMARY:

APN: 083-741-06  
 SITE AREA: 58.50 AC (APPROX)  
 ZONING: OBP (OFFICE/BUSINESS PARK)  
 BP (BUSINESS PARK)

PROPOSED BUILDING 'A1' 50,000 SF  
 PROPOSED BUILDING 'A2' 50,000 SF  
 PROPOSED BUILDING 'B' 252,000 SF  
 PROPOSED BUILDING 'C' 273,000 SF  
 PROPOSED BUILDING 'D' 182,000 SF  
 TOTAL PROPOSED FOOTPRINT 607,000 SF

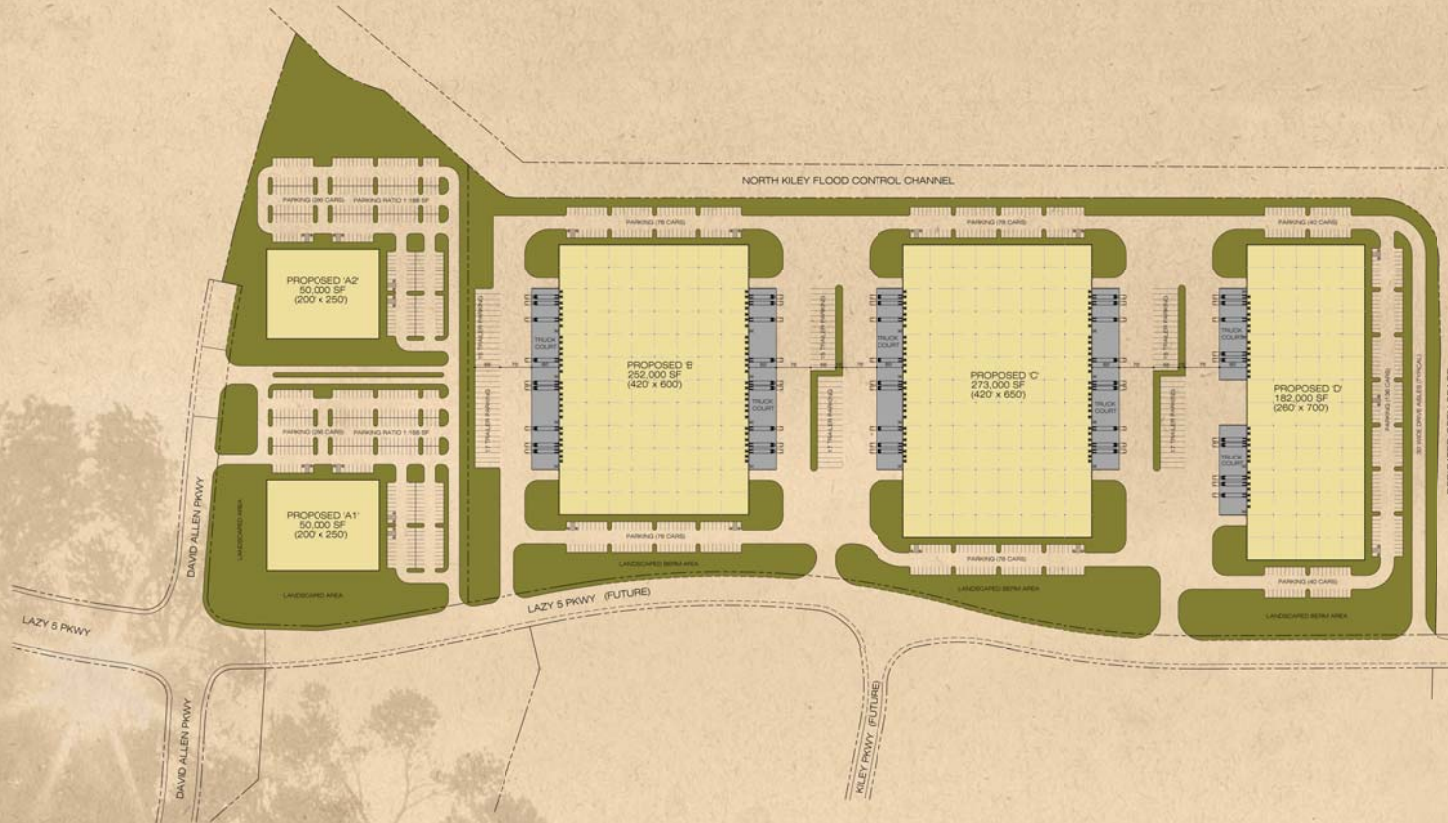

[Dermody.com/Kiley](http://Dermody.com/Kiley)

The information contained herein has been given to us by the owner of the property or other sources we deem reliable. We have no reason to doubt its accuracy, but we do not guarantee it. All information should be verified prior to purchase or lease.